

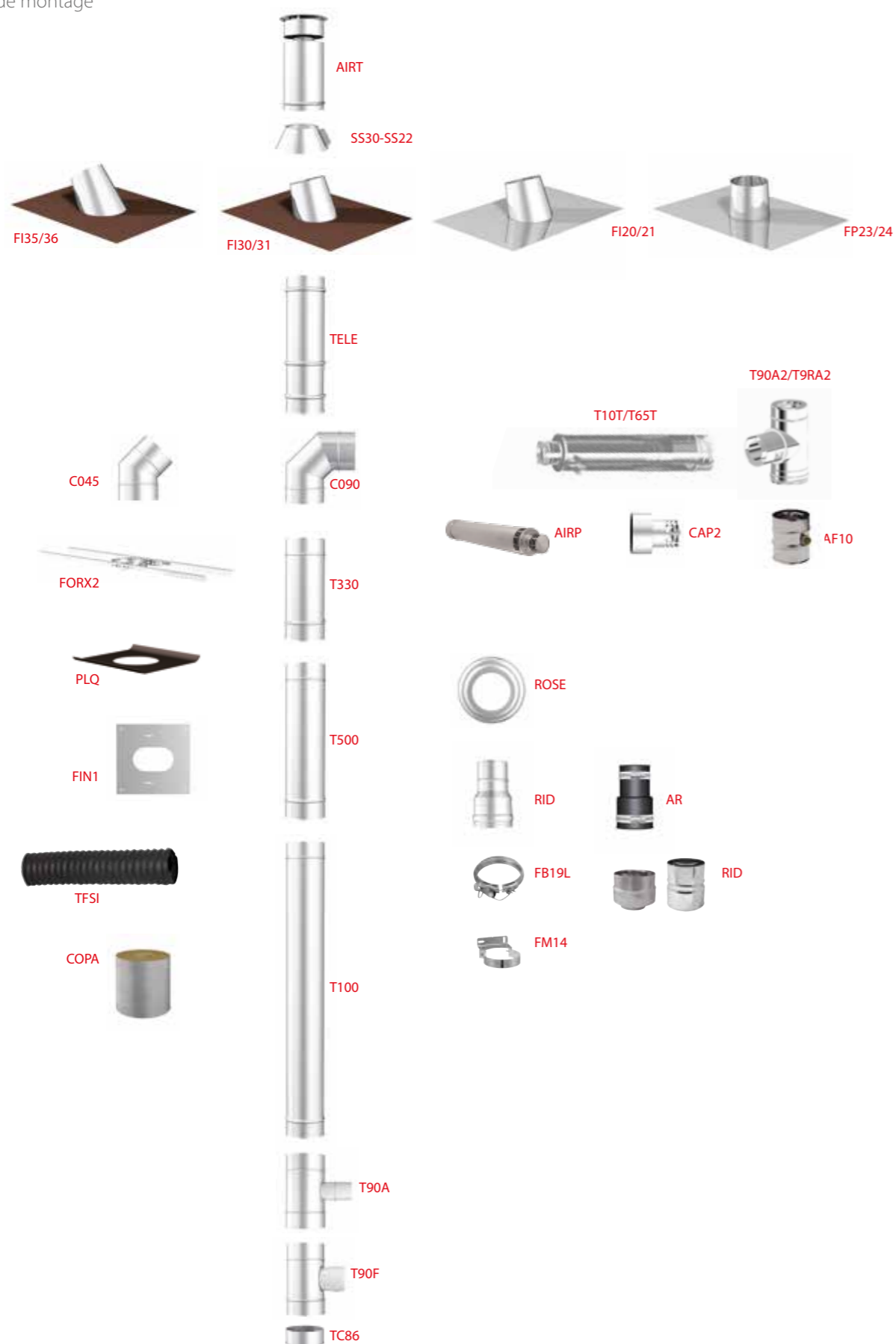

# APOLLO



Sistema camino coassiale in doppia parete in acciaio inox 316L sp.0,4 mm coibentato aria.

La tubazione interna e la tubazione esterna formano due vie di flusso:

- nella via centrale vengono espulsi i fumi che si formano dalla combustione
- nella via più esterna, tramite il terminale, convoglia l'aria che viene aspirata dall'apparecchio termico.

Air insulated concentric double wall pipe in stainless steel 316L thickness 0.4 mm.

The inner pipe and the external pipe form two flow paths:

- combustion fumes are expelled by the inner pipe
- in the outer pipe, the combustible air is conveyed from the cap to the generator.

Système de cheminée concentrique à double paroi en acier inoxydable 316L épaisseur 0,4 mm isolé à l'air.

Le tuyau interne et le tuyau externe forment deux voies d'écoulement:

- les fumées de combustion sont expulsées par le tuyau intérieur
- dans le tuyau extérieur, l'air combustible est amené du chapeau au générateur.

T450-N1-W-V2-L50040-G100

Ø disponibili  
Ø available  
Ø disponibles

80 e 100 mm

Finiture disponibili  
Available finishes  
Finitions disponibles





### T330

Elemento lineare  
Linear element - Élément droit

Finiture disponibili - Available finishes - Finitions disponibles

F.08 - ACCIAIO INOX STAINLESS STEEL - ACIER INOX		F.13 - NERO BLACK - NOIR		Øi	Øe	L	⊞
AK080T330		PAK080T330		80	125	330	1
AK100T330		PAK100T330		100	150	330	1

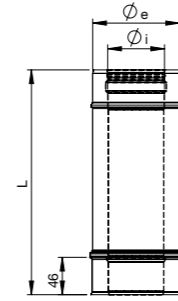

### T500

Elemento lineare  
Linear element - Élément droit

Finiture disponibili - Available finishes - Finitions disponibles

F.08 - ACCIAIO INOX STAINLESS STEEL - ACIER INOX		F.13 - NERO BLACK - NOIR		Øi	Øe	L	⊞
AK080T500		PAK080T500		80	125	500	1
AK100T500		PAK100T500		100	150	500	1

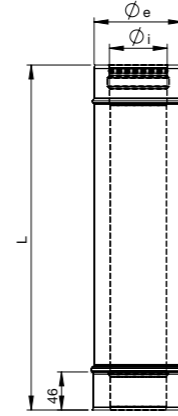

### T100

Elemento lineare  
Linear element - Élément droit

Finiture disponibili - Available finishes - Finitions disponibles

F.08 - ACCIAIO INOX STAINLESS STEEL - ACIER INOX		F.13 - NERO BLACK - NOIR		Øi	Øe	L	⊞
AK080T100		PAK080T100		80	125	1000	1
AK100T100		PAK100T100		100	150	1000	1

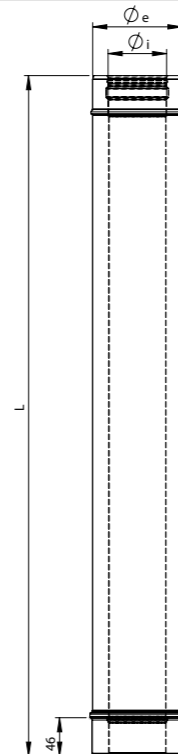

### TELE

Elemento telescopico  
Telescopic element - Élément télescopique

Finiture disponibili - Available finishes - Finitions disponibles

F.08 - ACCIAIO INOX STAINLESS STEEL - ACIER INOX		F.13 - NERO BLACK - NOIR		Øi	Øe	⊞
AK080TELE		PAK080TELE		80	125	1
AK100TELE		PAK100TELE		100	150	1

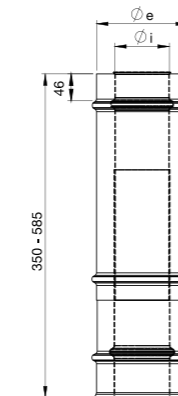

### AF10

Elemento lineare completo di analisi fumi M10-gas  
Linear element with smoke analysis M10-gas - Élément droit avec analyse des fumées M10-gaz

Finiture disponibili - Available finishes - Finitions disponibles

F.08 - ACCIAIO INOX STAINLESS STEEL - ACIER INOX		F.13 - NERO BLACK - NOIR		Øi	Øe	⊞
AK080AF10		PAK080AF10		80	125	1
AK100AF10		PAK100AF10		100	150	1

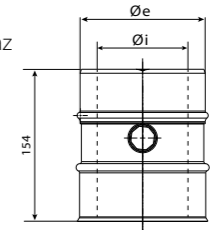

### T10T

Elemento coassiale telescopico  
Telescopic coaxial element - Élément télescopique concentrique

Finiture disponibili - Available finishes - Finitions disponibles

F.08 - ACCIAIO INOX STAINLESS STEEL - ACIER INOX		F.01 - NERO BLACK - NOIR		Øi	Øe	L min	L max	⊞
K080T10T		SK080T10T		80	125	660	990	1
K100T10T		SK100T10T		100	150	660	990	1

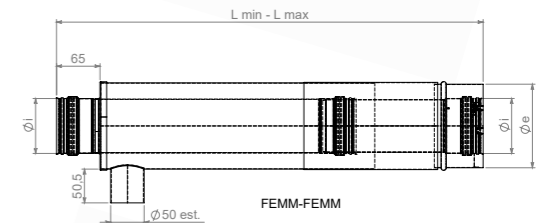

### T65T

Elemento coassiale telescopico per stufe a pellet  
Telescopic concentric element for pellet stoves  
Élément télescopique concentrique pour poêles à pellet

Finiture disponibili - Available finishes - Finitions disponibles

F.08 - ACCIAIO INOX STAINLESS STEEL - ACIER INOX		F.01 - NERO BLACK - NOIR		Øi	Øe	L min	L max	⊞
K080T65T		SK080T65T		80	125	450	650	1
K100T65T		SK100T65T		100	150	450	650	1

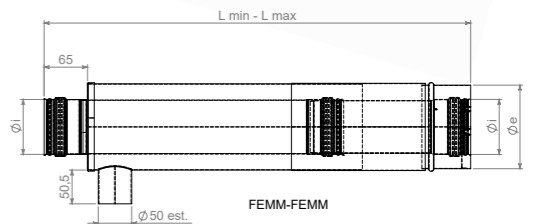

### C090

Curva a 90°  
90° Bend - Coude 90°

Finiture disponibili - Available finishes - Finitions disponibles

F.08 - ACCIAIO INOX STAINLESS STEEL - ACIER INOX		F.13 - NERO BLACK - NOIR		Øi	Øe	A	B	⊞
AK080C090		PAK080C090		80	125	157	151	1
AK100C090		PAK100C090		100	150	165	173	1

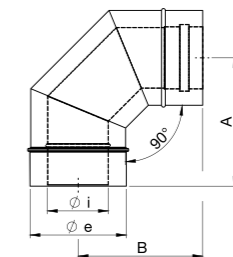

### C045

Curva a 45°  
45° Bend - Coude 45°

Finiture disponibili - Available finishes - Finitions disponibles

F.08 - ACCIAIO INOX STAINLESS STEEL - ACIER INOX		F.13 - NERO BLACK - NOIR		Øi	Øe	L	S	⊞
AK080C045		PAK080C045		80	125	291	100	1
AK100C045		PAK100C045		100	150	286	100	1

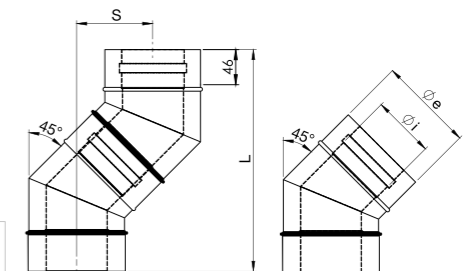

### T90F

Raccordo a "T" 90° con stacco femmina  
Tee pipe fitting with female coupler - Té 90° avec débouchure femelle

Finiture disponibili - Available finishes - Finitions disponibles

F.08 - ACCIAIO INOX STAINLESS STEEL - ACIER INOX		F.13 - NERO BLACK - NOIR		Øi	Øe	Ø	L	L1	L2	
AK080T90F		PAK080T90F		80	125	80	234	130	120	1
AK100T90F		PAK100T90F		100	150	80	260	130	130	1
AK100T90F_I100		PAK100T90F_I100		100	150	100	260	130	130	1

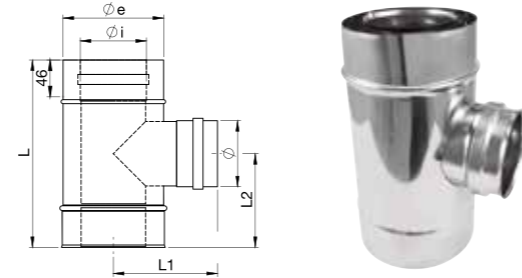

### T90A

Raccordo a "T" 90° con stacco per tubo flessibile  
Tee pipe fitting with coupler for flexible pipe  
Té 90° avec débouchure pour tubage flexible

Finiture disponibili - Available finishes - Finitions disponibles

F.08 - ACCIAIO INOX STAINLESS STEEL - ACIER INOX		F.13 - NERO BLACK - NOIR		Øi	Øe	Ø	L	L1	L2	
AK080T90A		PAK080T90A		80	125	60	234	150	116	1
AK100T90A		PAK100T90A		100	150	60	256	160	130	1

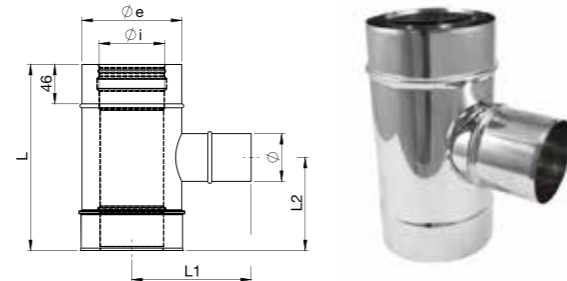

### T90A2

Raccordo a "T" 90° aerato ridotto Ø 100 maschio  
Tee pipe fitting reduced Ø male with air intake  
Té 90° réduit Ø mâle avec prise d'air

Finiture disponibili - Available finishes - Finitions disponibles

F.08 - ACCIAIO INOX STAINLESS STEEL - ACIER INOX		F.10 - NERO BLACK - NOIR		Øi	Øe	Øa	Øb	L1	L	
K100T90A2		PY100T90A2		100	150	100	150	121	325	1

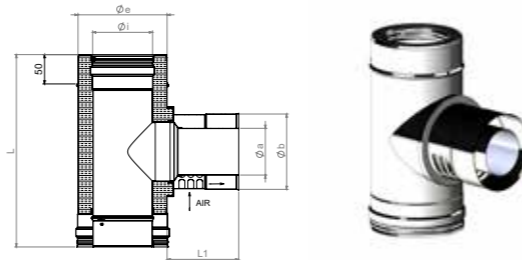

### T9RA2

Raccordo a "T" 90° aerato ridotto Ø 80 maschio  
Tee pipe fitting reduced Ø 80 male with air intake  
Té 90° réduit Ø 80 mâle avec prise d'air

Finiture disponibili - Available finishes - Finitions disponibles

F.08 - ACCIAIO INOX STAINLESS STEEL - ACIER INOX		F.10 - NERO BLACK - NOIR		Øi	Øe	Øa	Øb	L1	L	
K100T9RA2		PY100T9RA2		100	150	80	125	121	325	1

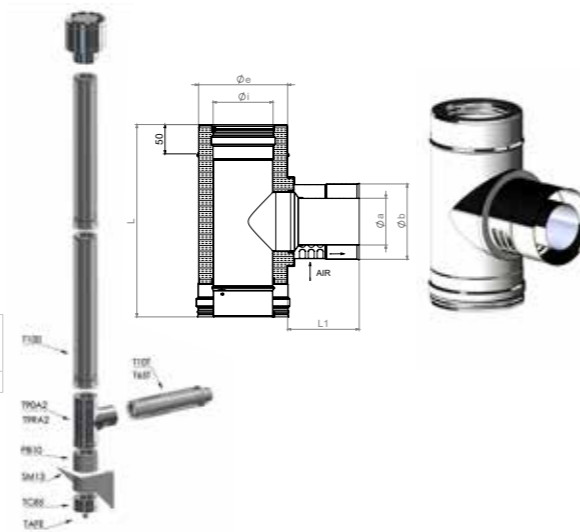

### TC86

Tappo cieco raccogli condensa  
Blind Tee cap - Tampon sans purge

Finiture disponibili - Available finishes - Finitions disponibles

F.08 - ACCIAIO INOX STAINLESS STEEL - ACIER INOX		F.13 - NERO BLACK - NOIR		Ø	
AK080TC86		PAK080TC86		125	1
AK100TC86		PAK100TC86		150	1

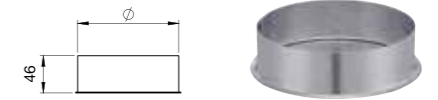

### RID/AR

Riduzione  
Reducer - Réduction

CODICE CODE - CODE	Ø1	Ø2		
RID080F060M	80F	60M	1	
AR60F40F	60F	40F	1	in EPDM
AR60F50F	60F	50F	1	in EPDM



### RID

Riduzione  
Reducer - Réduction

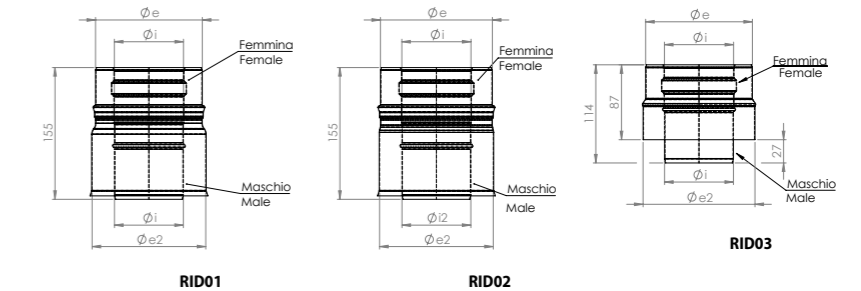

Finiture disponibili - Available finishes - Finitions disponibles

F.08 - ACCIAIO INOX STAINLESS STEEL - ACIER INOX		F.13 - NERO BLACK - NOIR		Ø1	Ø12	Øe	Øe2	
AKRID01		PAKRID01		80	-	125 per Apollo	130 per CMG, Edilkamin, Jolly Mec	1
AKRID02		PAKRID02		80	100	130	150 per CMG, Edilkamin, Jolly Mec	1
AKRID03		-		80	-	125	130 per Casatelli, Jotul, Palazzetti, Turbofonte	1





### FP23/24

Faldale per tetti piani

Flashing for flat roofs - Solin pour toits plats

#### ALLUMINIO ALUMINIUM ALUMINIUM

F.08 - ACCIAIO INOX STAINLESS STEEL - ACIER INOX	F.10 - NERO BLACK - NOIR	Ø	L1	L2	📦
J130FP23	PJ130FP23	130	550	650	1
J150FP23	PJ150FP23	150	550	650	1

#### PIOMBO LEAD PLOMB

F.08 - ACCIAIO INOX STAINLESS STEEL - ACIER INOX	F.10 - NERO BLACK - NOIR	Ø	L1	L2	📦
J130FP24	PJ130FP24	130	500	1000	1
J150FP24	PJ150FP24	150	700	1000	1

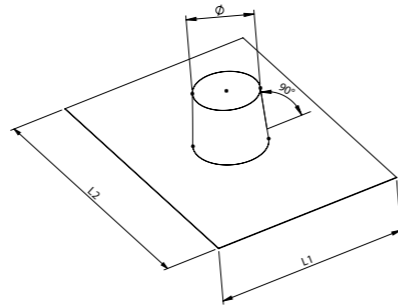

### FI20/21

Faldale per tetti inclinati da 10° a 35°

Flashing for sloped roofs from 10° to 35° - Solin pour toits inclinés de 10° à 35°

#### ALLUMINIO ALUMINIUM ALUMINIUM

F.08 - ACCIAIO INOX STAINLESS STEEL - ACIER INOX	F.10 - NERO BLACK - NOIR	Ø	L1	L2	📦
J130FI20	PJ130FI20	130	550	650	1
J150FI20	PJ150FI20	150	550	650	1

#### PIOMBO LEAD PLOMB

F.08 - ACCIAIO INOX STAINLESS STEEL - ACIER INOX	F.10 - NERO BLACK - NOIR	Ø	L1	L2	📦
J130FI21	PJ130FI21	130	500	1000	1
J150FI21	PJ150FI21	150	700	1000	1

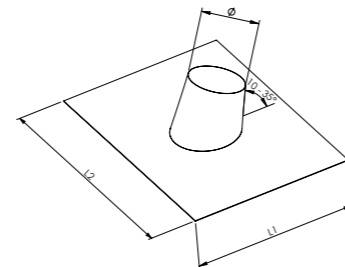

### SS22

Scossalina

Collar - Collettere de solin

#### Finiture disponibili - Available finishes - Finitions disponibles

F.08 - ACCIAIO INOX STAINLESS STEEL - ACIER INOX	F.10 - NERO BLACK - NOIR	Ø1	Ø2	📦
J150SS22	PJ150SS22	150	250	1

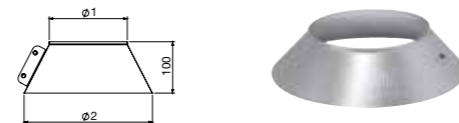

### FI30/31

Faldale con base in gomma per tetti inclinati da 5° a 32°

Flashing with rubber base for sloped roofs from 5° to 32°

Solin avec base en gomme pour toits inclinés de 5° à 32°

#### Finiture disponibili - Available finishes - Finitions disponibles

F.08 - ACCIAIO INOX STAINLESS STEEL - ACIER INOX	F.10 - NERO BLACK - NOIR	Ø	L1	L2	📦
J130FI30	PJ130FI30	130	560	688	1
J150FI30	PJ150FI30	150	560	715	1

Base in gomma rossa - Base in red rubber  
Base en gomme rouge

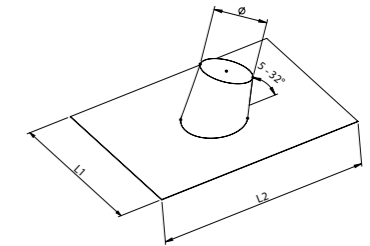
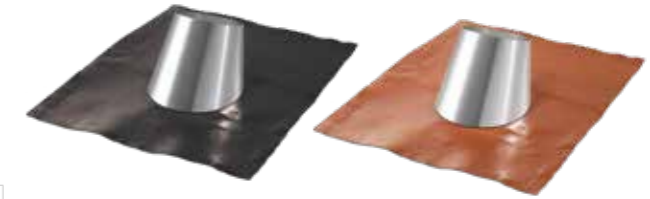

#### Finiture disponibili - Available finishes - Finitions disponibles

F.08 - ACCIAIO INOX STAINLESS STEEL - ACIER INOX	F.10 - NERO BLACK - NOIR	Ø	L1	L2	📦
J130FI31	PJ130FI31	130	560	688	1
J150FI31	PJ150FI31	150	560	715	1

Base in gomma nera - Base in black rubber  
Base en gomme noir

Faldale extra-flex con base adesiva, molto malleabile adattabile ad ogni tipologia di tetto.  
Flashing in extra-flex rubber with adhesive base, very malleable and adaptable to any type of sloped roof.  
Solin en extra-flex gomme avec base adhésive, très malléable et adaptable à chaque typologie de toit.

### FI35/36

Faldale con base in gomma per tetti inclinati da 33° a 45°

Flashing with rubber base for sloped roofs from 33° to 45°

Solin avec base en gomme pour toits inclinés de 33° à 45°

#### Finiture disponibili - Available finishes - Finitions disponibles

F.08 - ACCIAIO INOX STAINLESS STEEL - ACIER INOX	F.10 - NERO BLACK - NOIR	Ø	L1	L2	📦
J130FI35	PJ130FI35	130	560	685	1
J150FI35	PJ150FI35	150	560	715	1

Base in gomma rossa - Base in red rubber  
Base en gomme rouge

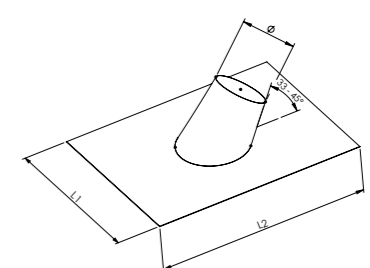
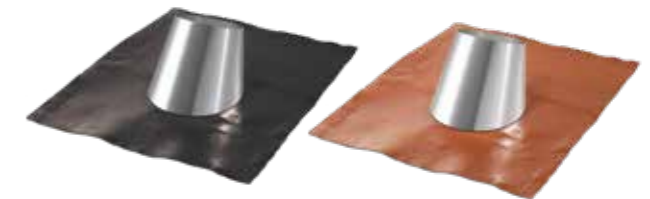

#### Finiture disponibili - Available finishes - Finitions disponibles

F.08 - ACCIAIO INOX STAINLESS STEEL - ACIER INOX	F.10 - NERO BLACK - NOIR	Ø	L1	L2	📦
J130FI36	PJ130FI36	130	560	685	1
J150FI36	PJ150FI36	150	560	715	1

Base in gomma nera - Base in black rubber  
Base en gomme noir

Faldale extra-flex con base adesiva, molto malleabile adattabile ad ogni tipologia di tetto.  
Flashing in extra-flex rubber with adhesive base, very malleable and adaptable to any type of sloped roof.  
Solin en extra-flex gomme avec base adhésive, très malléable et adaptable à chaque typologie de toit.

### SS30

Scossalina

Collar - Collettere de solin

#### Finiture disponibili - Available finishes - Finitions disponibles

F.08 - ACCIAIO INOX STAINLESS STEEL - ACIER INOX	F.13 - NERO BLACK - NOIR	Ø1	Ø2	📦
J125SS30	PJ125SS30	125	225	1

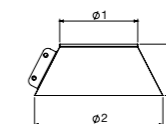



**AIRP**  
 Terminale orizzontale  
 Horizontal cowl - Terminal horizontal

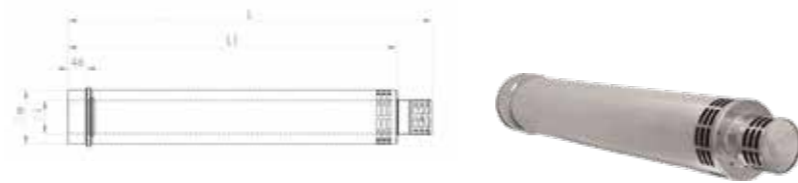

Finiture disponibili - Available finishes - Finitions disponibles

F.08 - ACCIAIO INOX STAINLESS STEEL - ACIER INOX		F.13 - NERO BLACK - NOIR		Øi	Øe	L	L1	☐
AK080AIRP		PAK080AIRP		80	125	875	800	1
AK100AIRP		PAK100AIRP		100	150	875	800	1

**CAP2**  
 Griglia di scarico orizzontale  
 Horizontal grill cowl - Chapeau horizontal avec grille de décharge

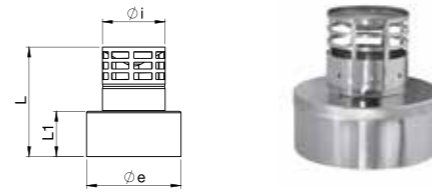

Finiture disponibili - Available finishes - Finitions disponibles

F.08 - ACCIAIO INOX STAINLESS STEEL - ACIER INOX		F.13 - NERO BLACK - NOIR		Øi	Øe	L	L1	☐
AK080CAP2		PAK080CAP2		80	150	140	60	1
AK100CAP2		PAK100CAP2		100	175	140	60	1

**AIRT**  
 Terminale concentrico  
 Concentric cowl - Terminal concentrique

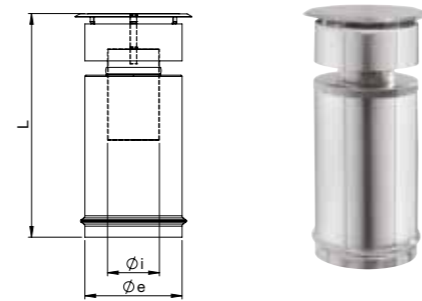

Finiture disponibili - Available finishes - Finitions disponibles

F.08 - ACCIAIO INOX STAINLESS STEEL - ACIER INOX		F.13 - NERO BLACK - NOIR		Øi	Øe	L	☐
AK080AIRT		PAK080AIRT		80	150	340	1
AK100AIRT		PAK100AIRT		100	175	340	1

**KIT01**  
 Kit condotto con uscita superiore  
 Ducting upper outlet kit - Kit étanche sortie plafond



CODICE CODE - CODE	Øi	Øe	☐
AK080KIT01	80	125	1
AK100KIT01	100	150	1

**FM14**  
 Fascetta murale  
 Wall clamp - Bride murale

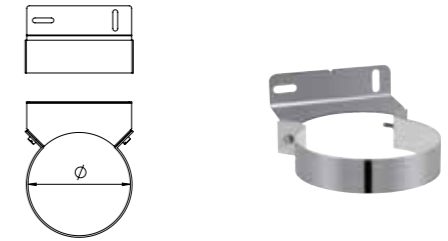

Finiture disponibili - Available finishes - Finitions disponibles

F.08 - ACCIAIO INOX STAINLESS STEEL - ACIER INOX		F.13 - NERO BLACK - NOIR		Ø	☐
AJ125FM14		PAJ125FM14		125	1
AJ150FM14		PAJ150FM14		150	1

**FB19L**  
 Fascetta di bloccaggio con leva  
 Locking band with draw latch - Bride de sécurité avec goupille



Finiture disponibili - Available finishes - Finitions disponibles

F.08 - ACCIAIO INOX STAINLESS STEEL - ACIER INOX		F.13 - NERO BLACK - NOIR		Ø	☐
AJ125FB19L		PAJ125FB19L		125	1
AJ150FB19L		PAJ150FB19L		150	1

**FORX2**  
 Fascetta con staffe L1000 mm per supporto a tetto  
 Clamp with brackets L1000 mm for roof support  
 Bride avec traversés L1000 mm pour support au toit

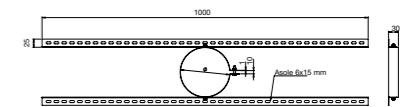

Finiture disponibili - Available finishes - Finitions disponibles

F.08 - ACCIAIO INOX STAINLESS STEEL - ACIER INOX		Ø	☐
Z125FORX2		125	1
Z150FORX2		150	1



## ROSE

Rosone  
Ring - Rosace

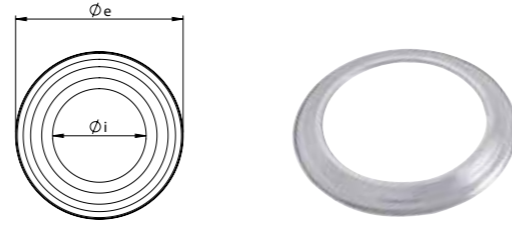

Finiture disponibili - Available finishes - Finitions disponibles

F.08 - ACCIAIO INOX STAINLESS STEEL - ACIER INOX		F.13 - NERO BLACK - NOIR		$\varnothing_i$	$\varnothing_e$	
AJ125ROSE		PAJ125ROSE		125	185	1
AJ150ROSE		PAJ150ROSE		150	210	1

## FIN1

Piastra quadrata di finitura da 0° a 30°

Square finishing plate from 0° to 30° - Plaque carrée de finition de 0° à 30°

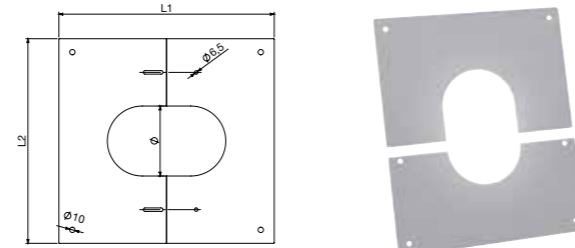

Finiture disponibili - Available finishes - Finitions disponibles

F.08 - ACCIAIO INOX STAINLESS STEEL - ACIER INOX		F.13 - NERO BLACK - NOIR		$\varnothing_i$	L1	L2	
AJ125FIN1		PAJ125FIN1		125	400	380	1
AJ150FIN1		PAJ150FIN1		150	400	400	1

## PLQ

Piastra in EPDM con base adesiva

Plate in EPDM with adhesive base - Plaque en EPDM avec base adhesive

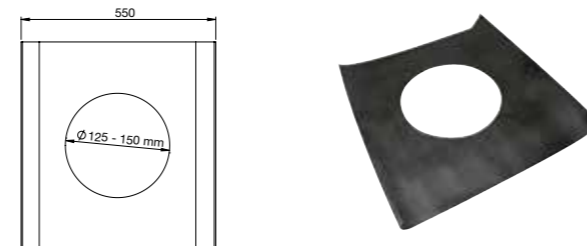

Finiture disponibili - Available finishes - Finitions disponibles

F.08 - ACCIAIO INOX STAINLESS STEEL - ACIER INOX		
AKUNVPLQ		1 in EPDM

## TFSI

Tubo flessibile in EPDM

Flexible pipe in EPDM - Tuyau flexible en EPDM



CODICE CODE - CODE	$\varnothing$	L	
AD060TFSI	60	1000	1 mt in EPDM

## COPA

Coppella con rivestimento in alluminio resistente fino a 600°C

Thermal insulation with aluminium coating resistant up to 600°C

Isolation thermique avec revêtement en aluminium résistant jusqu'à 600°C

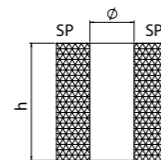

CODICE CODE - CODE	$\varnothing$	SP	h	
AK125COPA	125	100	350	1
AK150COPA	150	100	350	1

Coppelle in lana di roccia per canne fumarie densità 90kg/m<sup>3</sup> - Rock wool insulation for chimney systems density 90 kg/m<sup>3</sup> - Isolation de laine de roche pour conduits de cheminée densité 90 kg/m<sup>3</sup>

## INSTALLAZIONE TIPO - CIRCUITO DI COMBUSTIONE A TENUTA STAGNA

INSTALLATION TYPE - COMBUSTION CIRCUIT BY SEALED CHAMBER

INSTALLATION TYPE - CIRCUIT DE COMBUSTION ÉTANCHE

